

User Manual for Installers

SOLARMAN Business is the 3rd generation platform especially designed for PV monitoring and O&M. And this user manual will guide you to operate account registration, plant creation, device addition, and authorization.

Let's get started!

Account Registration

If you do not have an account on SOLARMAN Business, please go to login page and register.

Step 1: Go to Login Page

Click **“Register”** as shown in the following page.

17:49 English

SOLARMAN
Monitored-Analysed Network

E-mail **Phone Number** Username

(China+86) Phone Number

Password(6~50 characters)

Register [Forgot your password?](#)

Log In

Current Version V1.5.8

Login Page

Step 2: Complete the Registration

1. Enter E-mail or Phone Number

- 1) Please enter a right E-mail or phone number, and verify it.
- 2) After verified its validity, please tick the box of ***T&Cs and Privacy Policy***.

Tip: SOLARMAN Business supports registration via phone number and E-mail, users can click the button as shown in the following page to switch.

17:53

🔔 📶 📶 📶 📶 🔋 78



Register

Enter E-mail or Phone Number

E-mail

Verification Code

[Send](#)

I have read and agreed [T&Cs](#) [Privacy Policy](#)

Next

[Switch to phone registration](#)

2. Enter Account Info

If a new account is created on SOLRMAM Business, please complete the account information here.

17:54

🔔 📶 📶 📶 📶 🔋 78



Register

Enter Account Info

*Name

Username

*Password At least 6 characters

Next

Create a Plant

Step 1: Go to Plants Page

Go to **[Business] - [Plant] - [+]**, or click the "+" in the upper-right corner and select "Create a Plant".

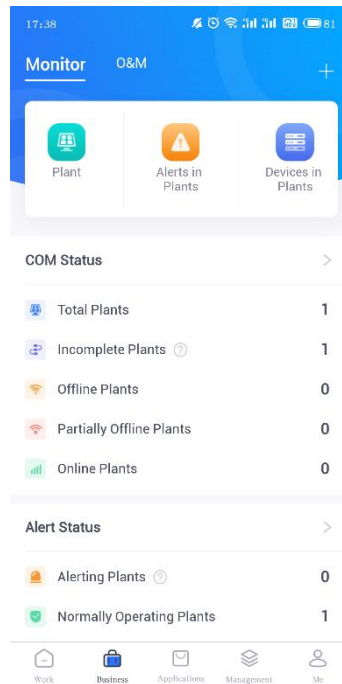

Step 2: Enter Plant Info

Please enter the plant information here. The asterisked fields are required.

1. Basic Info

Please enter Plant Name, Plant Location, Coordinates and other basic info here.

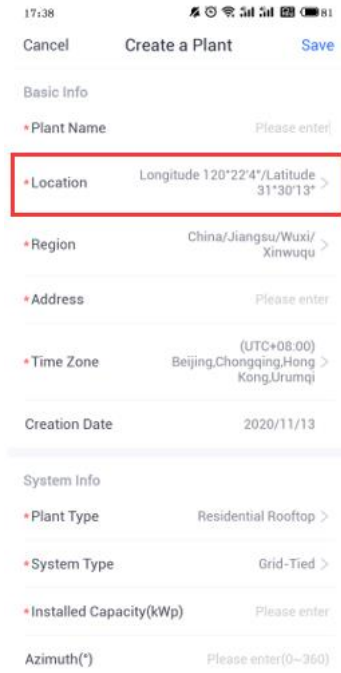

SOLARMAN Business APP will locate your current location automatically relevant information.

Go to Location field and search, system will automatically fill in the details according to what you enter.

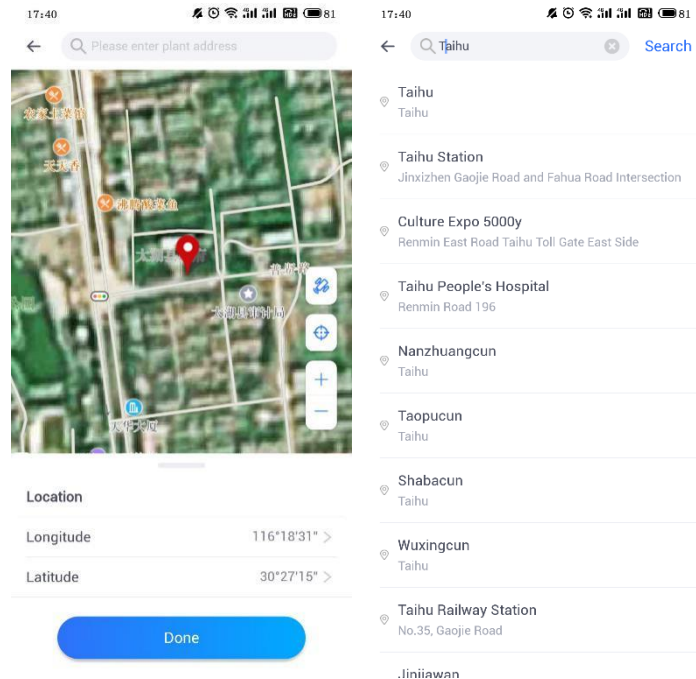

2. System Info

Please enter Plant Type, System Type, Capacity, Azimuth, Tilt Angle, and Commissioning Date here.

Notice: SOLARMAN Business will display plant layout according to System Type, and analyze plant data according to Capacity, please enter the fields correctly.

17:41 📶 📶 📶 📶 📶 📶 81

Cancel Create a Plant Save

System Info

* Plant Type Residential Rooftop >

* System Type Grid-Tied >

* Installed Capacity(kWp) Please enter

Azimuth(*) Please enter(0~360)

Angle of Tilt(*) Please enter(0~90)

* Commissioning Date 2020/11/13 >

3. Yield Info and Owner Info

Please enter Yield Info and Owner Info here.

Notice: Please double check the Currency field cause it will influence yield calculation.

Yield Info

* Currency CNY >

Unit Price(CNY/kWh) Please enter

Total Cost(CNY) Please enter

Owner Info

Contact Person Please enter

Phone Number Please enter

Business Name Please enter

4. Created

After all plant information is entered, click "Save" in the upper-right corner to complete.

Tip: Users can directly add a device or operate authorization here.

17:41 📶 📶 📶 📶 📶 📶 81

Cancel Create a Plant Save

Basic Info

* Plant Name Plant1

* Location Longitude 116°18'31"/Latitude 30°27'15" >

* Region China/Jiangsu/Wuxi/Xinwuqu >

* Address Please enter

* Time Zone (UTC+08:00) Beijing,Chongqing,Hong Kong,Urumqi >

Creation Date 2020/11/13

System Info

* Plant Type Residential Rooftop >

* System Type Grid-Tied >

* Installed Capacity(kWp) Please enter

Azimuth(*) Please enter(0~360)

17:42 📶 📶 📶 📶 📶 📶 80

Create a Plant Done



Plant created!

Please do the following operations

Add a New Gateway/Logger >

Please enter a gateway/logger SN which belongs to the plant, system will get data from the gateway/logger and its sub-system. You can skip it now and do it later in Plant Details.

Authorize Users >

Other users are eligible to check the plant after your authorization. You can skip it now and do it later in Plant Details.

Authorize Business Units >

Other business units are eligible to check the plant after your authorization. You can skip it now and do it later in Plant Details.

Authorize Internal Members >

Other members are eligible to check the plant after your authorization. You can skip it now and do it later in Plant Details.

Select Tags >

Add a Device

Go to Add a New Gateway/Logger field to add a device.

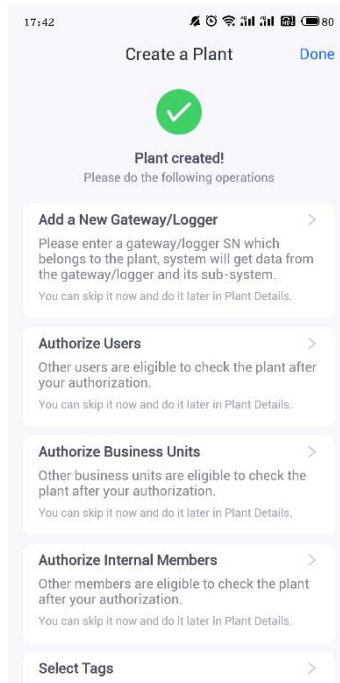

Click "+" in the upper-right corner and scan device bar code or QR code or enter device SN manually.

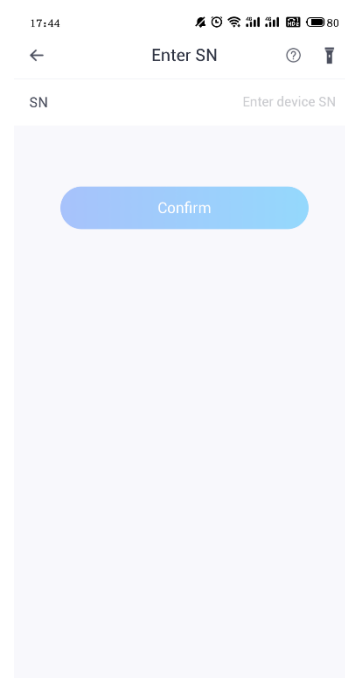
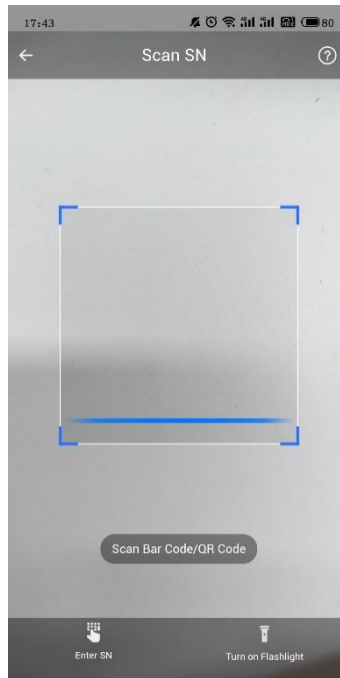
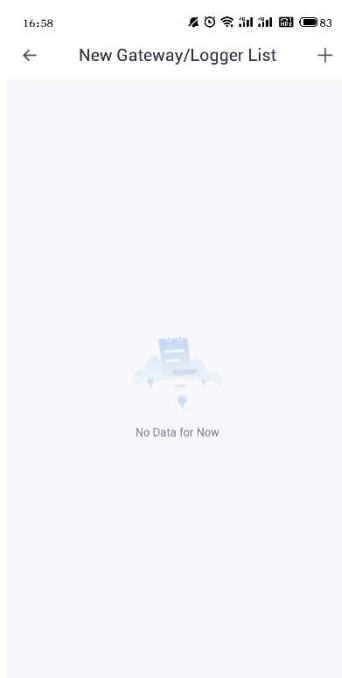

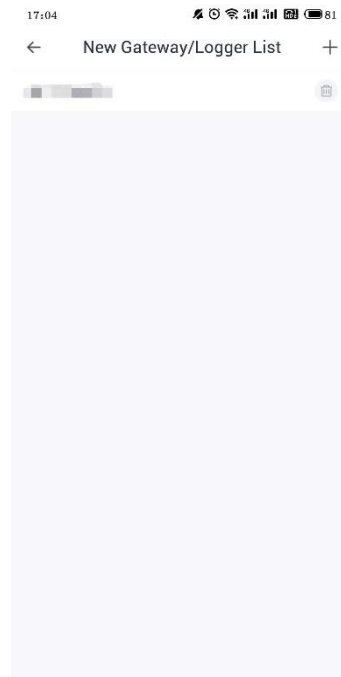
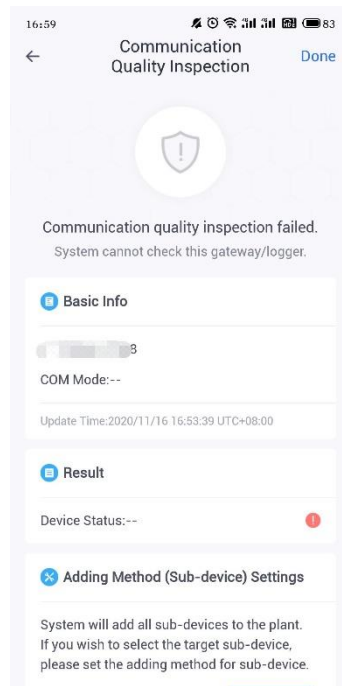

If the device is Logger (WiFi), please go to **WiFi Configuration** and click “Go to Configure” to operate network configuration.

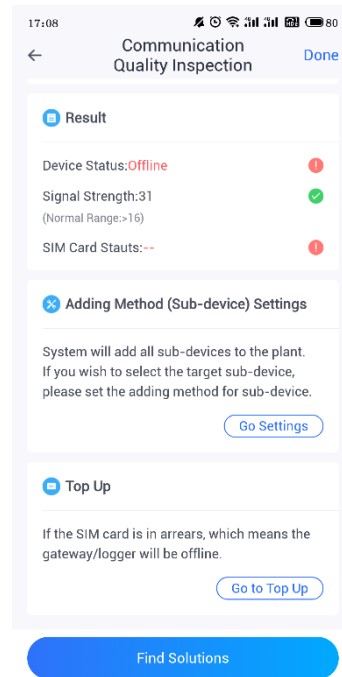
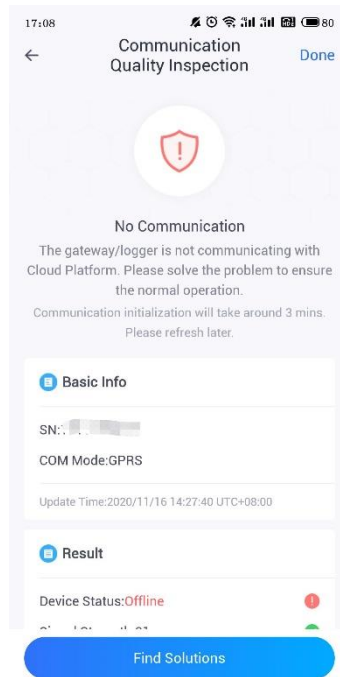

Authorization

Go to Authorize Users field to operate authorization.

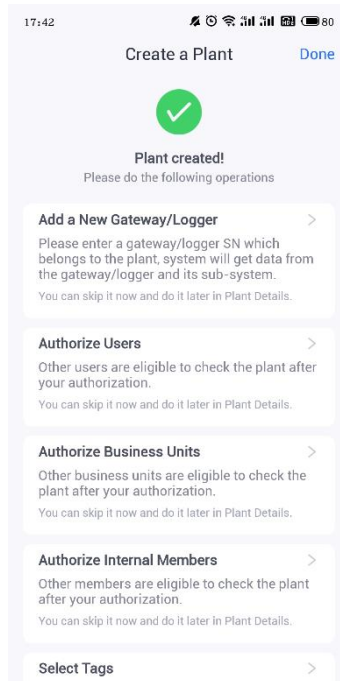

1. Create a New User

Click "⊕" in the upper-right corner and select "Create a New User".

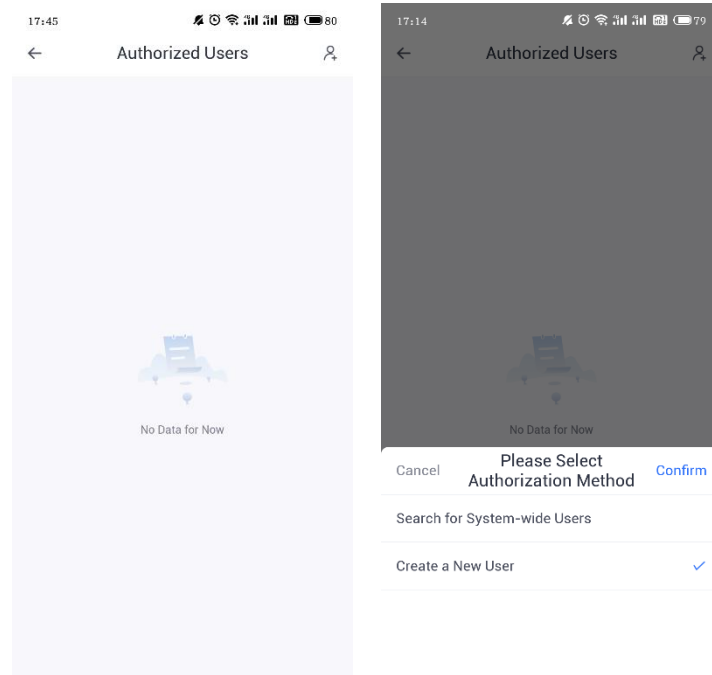

Please enter user information here and click "Save".

Notice: Users can select authorized external role here.

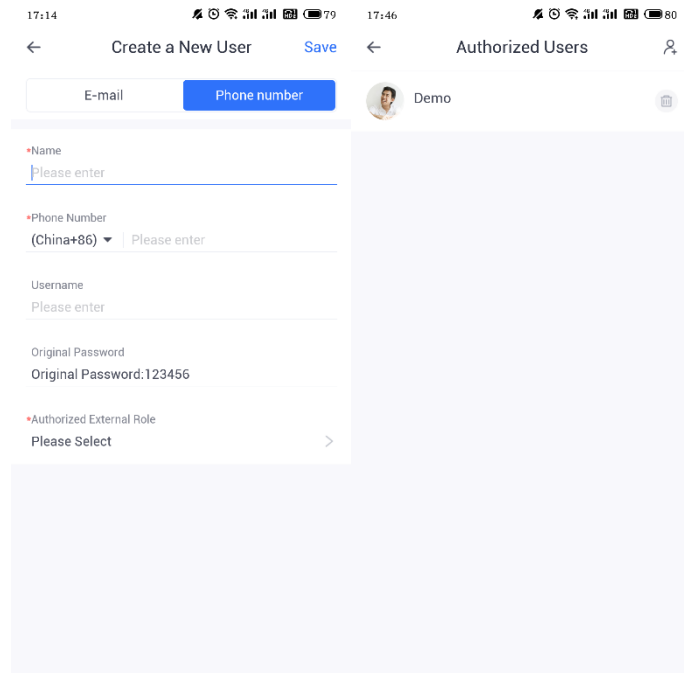

2. Search for System-wide Users

1. Click "🔍" in the upper-right corner and select "Search for System-wide Users".

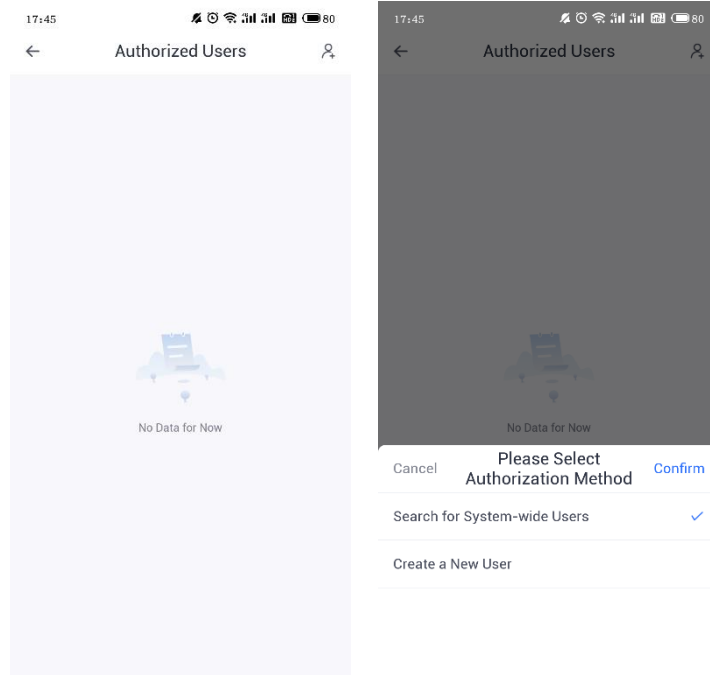

2. Enter the user information (e.g. name, E-mail, phone number) in the pop-up dialog to search for target user.

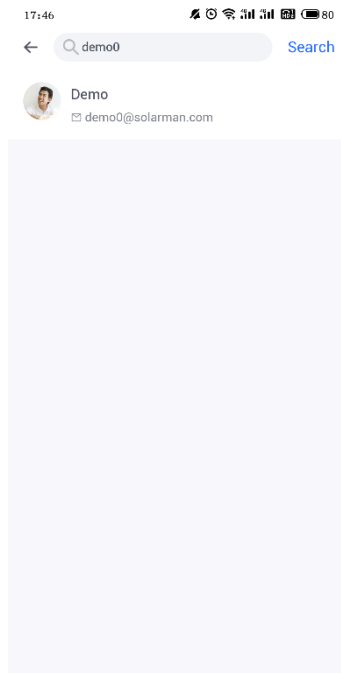

3. Select an external role and click "Save".

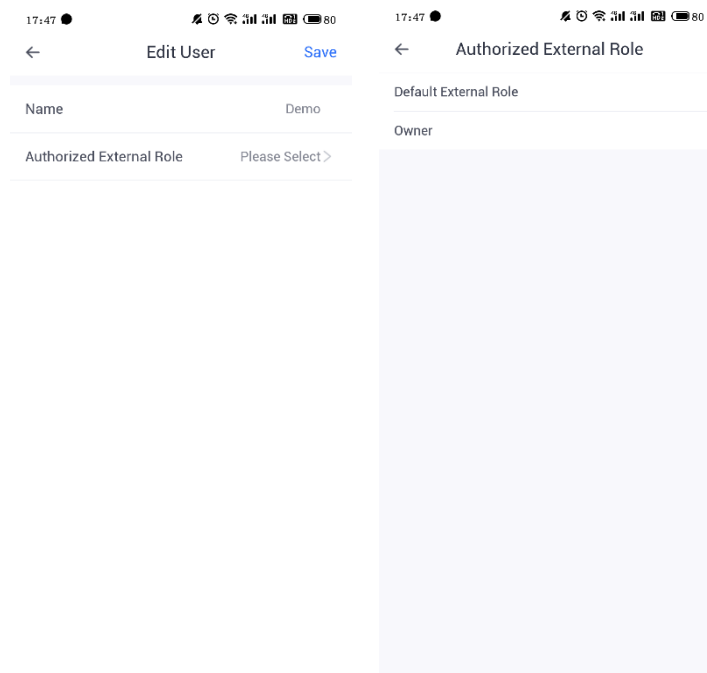

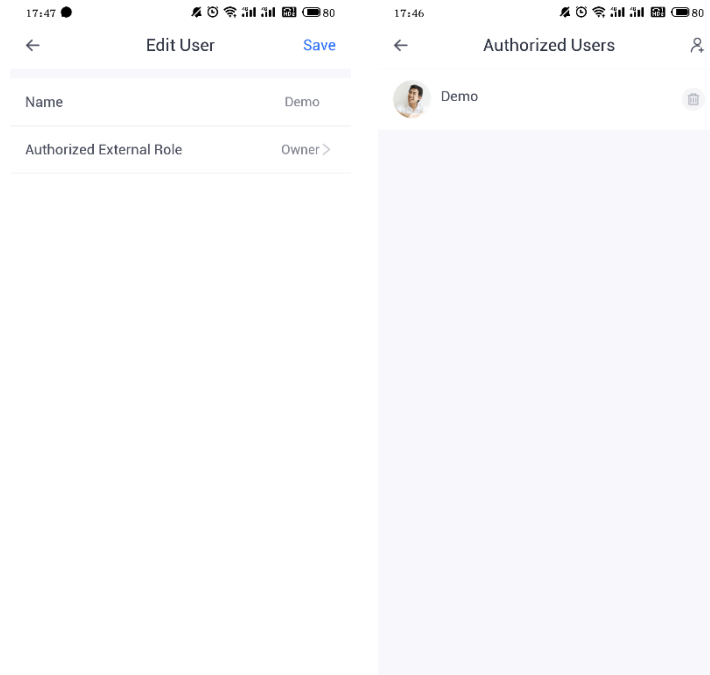

4. Click the "Done" in the upper-right corner to complete.

